

101 DEC/JAN 2017/18  
www.arc-magazine.com

arc

LIGHTING IN ARCHITECTURE

# WHERE THE LIGHT GETS IN

Jean Nouvel, 8'18" and BuroHappold create  
a stunning scheme for Louvre Abu Dhabi

WORKSPACE LIGHTING • THE PARANORMAL UNICORN • MARTIN KLAASEN  
PLDC • IALD ENLIGHTEN AMERICAS • SORAA ARC REVIEWED

FORMERLY  
**mondo**<sup>arc</sup>



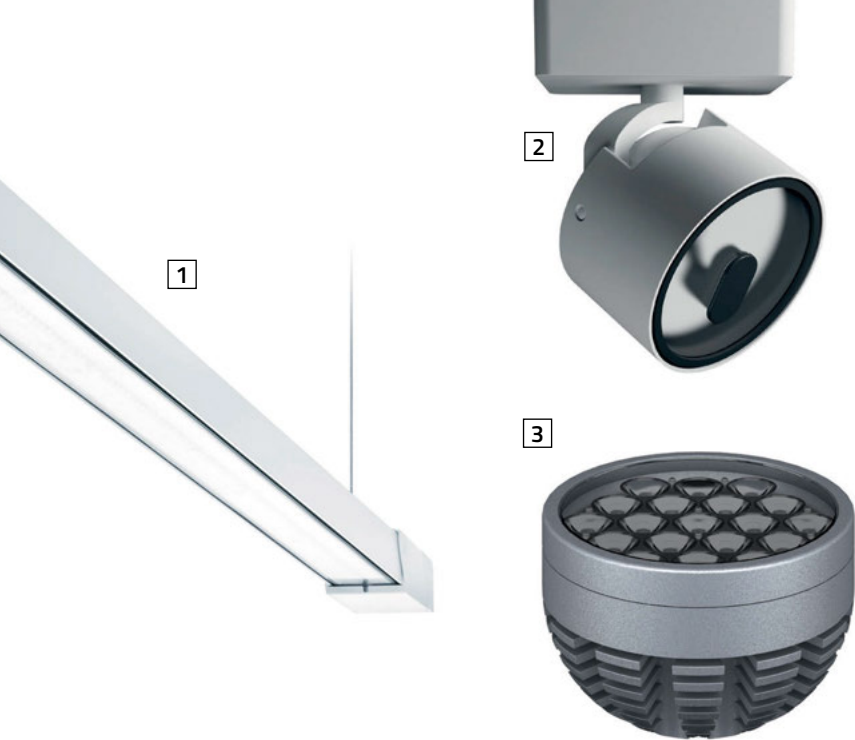

## Middle Eastern Promises

We take a closer look at some of the latest innovations on show at Light Middle East 2017.

### 1 TRINOS Zumtobel

The TRINOS industrial LED luminaire combines the flexibility and functionality of a trunking system with the durability of an IP65 solution. As a result, precise and high-quality work is supported in locations that demand higher protection against moisture and dust. A three-piece sealing concept ensures the highest levels of resistance, safety and performance at all times. The proven split-lens technology from the TECTON C portfolio is also used in the TRINOS luminaires, which are protected from contamination and moisture from above, below and at both ends.

[www.zumtobel.com](http://www.zumtobel.com)

### 2 ZENO NSP Targetti

ZENO NSP is the first projector in the Targetti portfolio equipped with the Narrow Spot optic system, developed to create a defined and precise beam. ZENO NSP is suitable for museum or retail lighting where a perfect visibility and illumination is needed. The NSP optic works by reflection: the lamp is hidden from sight and aimed towards the parabolic reflector, which collimates the beam and emits a particularly defined cone of light.

The discrete and elegant design of the product makes it able to perfectly integrate in every environment.

[www.targetti.com](http://www.targetti.com)

### 3 OVO 18UN Nexo Luce

OVO 18UN by Nexo Luce is designed to create a dramatic ultra-narrow light beam on façades and architectural surfaces. It is equipped with 3.5-inch optics for accurate projection while able to reach up to 59lux at 80-metres distance. This LED projector has an adjustable beam position; aluminium and stainless steel body AISI 316L; and is suitable for outdoor installations thanks to IP65 waterproof protection and thermal shock-resistant tempered safety glass.

[www.nexoluce.com](http://www.nexoluce.com)

### 4 3D LED Flex 40 IP65 System Radiant Lighting

The 3D LED Flex 40 IP65 System is a three-dimensionally flexible, high power, modular, linear LED lighting system, incorporating a patented articulated ball-joint system between the heatsink modules, allowing it to follow building surfaces that are non-linear with curved profiles and façades.

Each 100mm module incorporates four Luxeon Z red LEDs, a highly efficient 8-degree Gaggione lens, and custom anti-glare snoots. Each module is individually addressable via DMX.

[www.radiantlights.co.uk](http://www.radiantlights.co.uk)

### 5 P-10 SGM

The SGM P-10 low-profile, yet extremely powerful, full colour LED luminaire carries the functionalities of a washlight, a strobe light, a floodlight, a pixel light, and a blinder with a non-fading continuous output. It incorporates 48 high-power RGBW 24W LEDs with eight individually controllable segments and a staggering output of 40,000 lumens. With all this crossover technology combined in one single luminaire, SGM's P-10 is truly the perfect multi-purpose LED fixture and a solid long-term investment.

[www.sgmlight.com](http://www.sgmlight.com)

### 6 Beacon Muse XL Concord

The Concord Beacon Muse XL provides total control and adjustability of both beam angle and light levels combined with typical Ra97 colour rendering, offering a truly flexible product for gallery and display applications. The Beacon Muse XL features intelligent LED technology and ancient lens principles to create a fully adjustable spotlight. Boasting an increased output over the original Beacon Muse, the luminaire provides a flexible, high quality solution. The beam angle can be adjusted from ten to 70-degrees as well providing a dimmable range between 5-100%.

[www.concord-lighting.com](http://www.concord-lighting.com)